

MICRO CANAL

MAXIMUM WARMTH, MINIMUM DIMENSIONS

The latest Jaga trench heating solution is only 60 mm high and 130 mm wide.

With small, but powerful dynamic Low-H₂O heat exchangers and super-quiet fans that are no wider than a thermostatic radiator valve, it creates immense power.

Micro Canal combines minimalist aesthetics and architectural freedom with a power that breaks all temperature records!

Micro Canal integrates harmoniously with any interior. This provides every architect, designer or engineer the greatest possible design freedom on any project without making any compromises for the heating system.

By using the latest EC motors, Micro Canals consume up to 50% less electricity than traditional motors.

PRESENTING MICRO CANAL



CREATE
EMOTION

MICRO CANAL

DIMENSIONS (in mm)

Inner casing

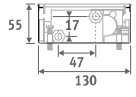
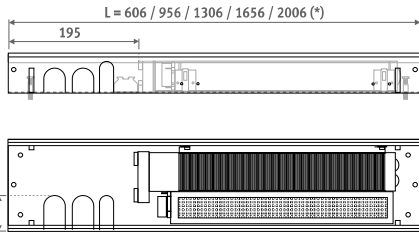

(* In case of through-mounting, do not install the intermediate tops. Reduce length by 3 mm for each top.

Outer casing

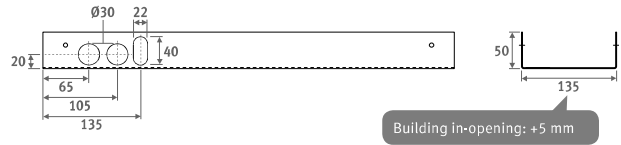

With energy efficient EC motor

HYDRAULIC CONNECTION

- one-sided 2-pipe connection on the left
- always install Micro Canal with the heat exchanger on the window or wall side
- 2 x 1/2" stainless steel hose included
- allow extra space for curtains, in between the window and the Micro Canal.
- The heat exchanger must always be kept accessible for maintenance purposes

- if the appliance is not mounted flat on the floor, the space between the bottom of the appliance and the floor should be filled with a stable filler material.

ELECTRIC CONNECTION

- clamp connector for electrical connection 24 VDC to the left, to be connected via external power supply. Install a thermostat with a potential-free contact to control the water supply with the help of a zone valve. Micro Canal automatically switches on the activators via a temperature sensor.

COMPOSITION

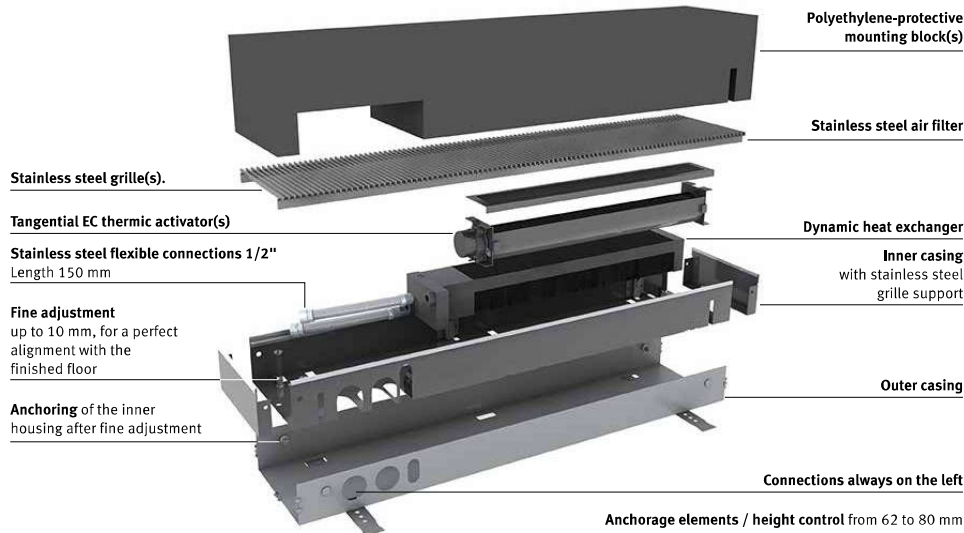

ORDERING CODE

code	height	length	width	grille
MIRF .	006	060	14	./SSS
<i>fill in grille code</i>				

DELIVERY

Product is made to order, please contact our customer service team on 01531 631 533 to discuss your requirements.

MICRO CANAL

			HEATING			ACTIVATORS	SOUND PRESSURE*	POWER CONSUMPTION	AIR FLOW
			Watts	Watts	Watts	quantity	dB(A)	Watts	with clean filters
H	L	B	75/65/20°C	55/45/20°C	35/30/20°C				m ³ /h
60	600	140	390	234	98	1	18.0	1.6	29.3
	950		780	468	195	1	21.0	1.9	58.5
	1300		1170	702	293	1	22.8	2.2	88.0
	1650		1560	936	390	2	24.0	3.1	117.0
	2000		1950	1170	488	2	25.0	3.5	146.5

* With an assumed room attenuation of 8 dB(A) / content of the room 75 m³ / reverberation time 0.5 sec. / measured at 1 m height and 2 m from the appliance.
Correction factors & pressure drop: see "Technical info" chapter

RECOMMENDED COMBINATIONS

	Heating
Product	Micro Canal
Power supply	Power supply: ordering code 37603.010002
Connection set	Connection set 92 with 2 lockshields CODY.LOA.00.3... <i>(fill in sleeve coupling code: see p. 312)</i>

OVERVIEW GRILLES

Stainless steel grilles



SSS stainless steel

Stainless steel grilles lacquered

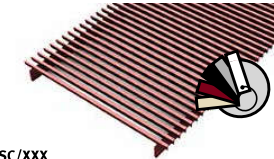

SSC/XXX stainless steel lacquered

To ensure perfect adherence of the lacquer coating, an extremely wear-resistant and UV-resistant polyester lacquer coating of the highest quality is used. Only in glossy (code 2..) and special colours 006, 005, 026, 028.

STANDARD DELIVERY

ASSEMBLY & PROTECTION BLOCK

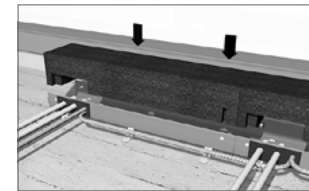

Install the polyethylene protective block(s) as protection on the construction site.

DESIGN GRILLES

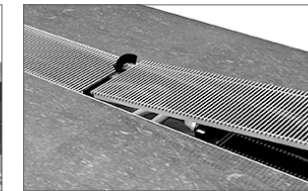

Continuous design grille of stainless steel grilles.

HEIGHT CONTROL

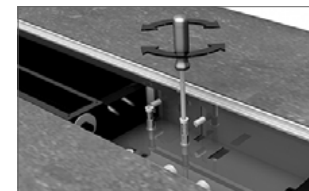

Double height adjustment by means of the anchoring on the outer casing and by fine adjustment with the bolts in the inner housing (adjustable from 62 to 80mm).

FLEXIBLE CONNECTION

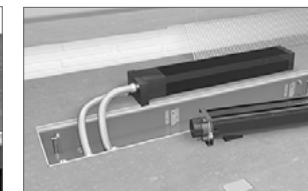

Stainless steel flexible hoses (150 to 250mm), enabling the internal mechanism to be removed completely for easy cleaning.

MICRO CANAL - OPTIONS

POWER SUPPLY DIN-RAIL MONTAGE



The guarantee is only valid if the original Jaga power supply is used.

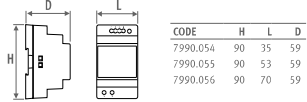

- for DIN-rail or wall mounting
- conformity UL60950 / UL508 / IEC 60950-1 / TUV EN61558-2-16 / Class 2
- output voltage 24 VDC
- input voltage 100 - 240 VAC
- screw connection
- LED indicator

CODE	Output	
	Watts	Output current A
7990.054	36	1.5
7990.055	60	2.5
7990.056	92	3.9

Required power = sum of the power consumption of the devices

MAXIMUM CABLE LENGTH

In function of the number of devices: see <http://www.jaga.co.uk/en/products/trench-heating/micro-canal>

SEPARATE POWER SUPPLY

Waterproof power supply 24 VDC/30 Watt with waterproof cable gland.



! Not suitable for installation in the floor duct.

- conformity: UL60950 - EN 60950 / Class 2
- output voltage 24 VDC
- input voltage 100 - 240 VAC
- dimensions L 145 x B 45 x H 30 cm

CODE	Output	
	Watts	Output current A
37603.010002	30	1.25

VALVES

See page 96

JAGA TWO-WAY VALVE AND THERMOELECTRIC DRIVE 230 VAC



- only for mounting on the distributor, not in the Micro Canal!
- with varistor to protect against power surge
- with position indicator (open/closed)
- sleeve couplings have to be provided by the installer

CODE	Description
7990.409	180° - G1/2" F / NG 230V 2Watts
7990.411	180° - G3/4" F / NG 230V 2Watts

VALVE UNIT



- length 350mm
- motorised thermostatic valve 24 VDC with lockshield
- outer casing with height control
- inner casing with stainless steel grille support
- stainless steel grille, natural coloured or lacquered
- protection block

CODE	Description
7522.00603514/SSS/VC	
7522.00603514/SSC/.../NC	

fill in colour code

! Order sleeve couplings M24

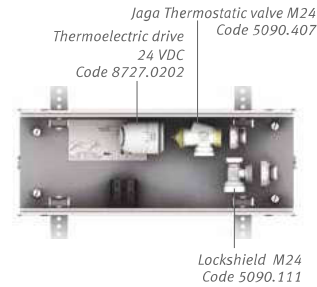

EMPTY HOUSING

To fill open spaces for a continuous installation.



- outer casing with height control
- inner casing with stainless steel grille support
- stainless steel grille, natural coloured or lacquered
- protection block(s)
- 2 head pieces

empty housing with stainless steel grille

CODE	L
7522.00603514/SSS	350
7522.00606014/SSS	600
7522.00609514/SSS	950
7522.00613014/SSS	1300
7522.00616514/SSS	1650
7522.00620014/SSS	2000

empty housing with lacquered stainless steel grille

CODE	L
7522.00603514/SSC/...	350
7522.00606014/SSC/...	600
7522.00609514/SSC/...	950
7522.00613014/SSC/...	1300
7522.00616514/SSC/...	1650
7522.00620014/SSC/...	2000

enter colour code

CORNER PIECE



- aluminium cover plate in stainless steel effect (SSS), or lacquered in other Jaga colours (SSC)
- outer casing with anchorage elements
- polyethylene-protective mounting block(s)
- fully assembled inner housing with stainless steel grille support
- height adjustment with fine adjustment for alignment with the finished floor

Outer corner

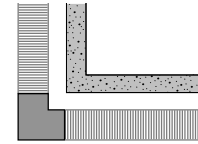

CODE	Description
7522.00602014/SSS/02	Natural
7522.00602014/SSC/.../02	lacquered

enter colour code

Inner corner

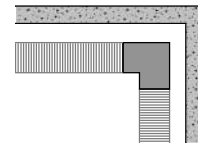

CODE	Description
7522.00602014/SSS/01	Natural
7522.00602014/SSC/.../01	lacquered

enter colour code

MICRO CANAL - OPTIONS

FEET WITH HEIGHT ADJUSTMENT FOR RAISED FLOORS

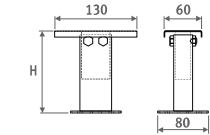

- lacquered in dark grey RAL 7024.
- easy installation by means of "stainless steel spring system"
- 1 set includes 2 height adjusting controls

Number of sets per Micro Canal

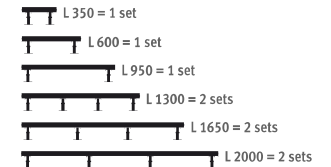

CODE	H
5207.05070000	50 > 70 mm
5207.08130000	80 > 130 mm
5207.13230000	130 > 230 mm
5207.20300000	200 > 300 mm